

HALL PLANS

Hall 8

As a banqueting hall, Hall 8 can dine up to 280 guests and with the full support of our experienced catering team, you can create and host your perfect event.

In addition, this high-specification hall can be used as a conferencing facility for up to 306 delegates, offering a comprehensive level of technical support. It can also be sub-divided for further flexibility.

ICC
Birmingham



Hall Plan.

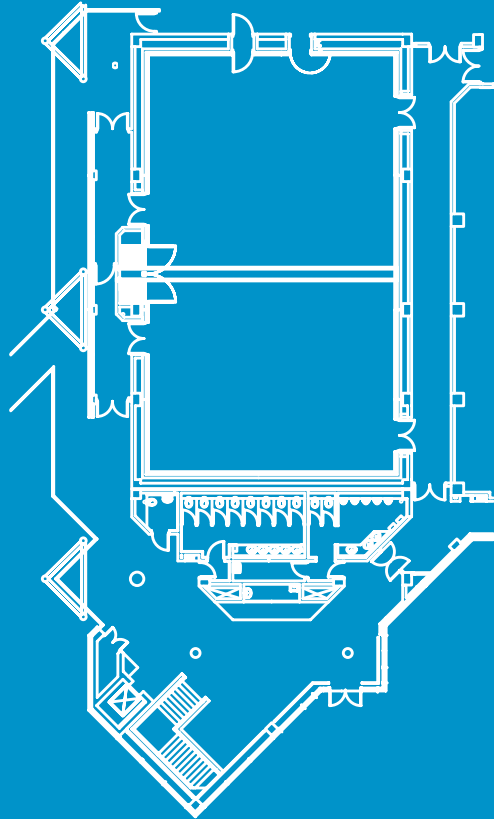

Key Details.

Additional Items	
AV Control Rooms	Y
Simultaneous interpretation booths	N
Divisible	Y
Fixed Stage	N
Stage access for cars and trucks	N
Organiser offices/Dressing rooms	N
Daylight	N
Foyer	Y
Bar	Y

Seating Capacity	
Theatre	306
Cabaret	168*
Classroom	180
Boardroom	100
Banquet	280**

Please note that final numbers are subject to room layout.
 *Cabaret numbers are based on tables of seven with a stage.
 **Banqueting numbers are based on oval tables of ten without a stage.

Conference Rental Package includes:



Seating Capacity.
 Up to 306 theatre style; sub-divisible into 2 halls each seating up to 150 and 170 delegates respectively; up to 280 dining (based on oval tables of 10); up to 400 for receptions.



Stage.
 Up to 7.5m wide x 4m deep x 0.15m high.



Stage Equipment.
 Lectern; top table for 3 people; 32 amp single phase power supply available as 13 amp sockets.



Sound.
 High quality conference sound system with up to 4 cabled microphones.



Light.
 Dimmable house and conference lighting systems.



Presentation.
 Data video projector; PC with internet access; projection source switcher; 4.2m wide projection screen; laser pointer.



Technical Support.
 1 technician available for up to 9 continuous working hours, between 06:00 and 22:00 hours.



Disabled Facilities.
 Hall 8 is fully accessible for wheelchair users.



Additional Facilities.
 Dedicated foyer area with bar. Goods lift.

A full technical specification is available on request.

Dimensions

Floor area	319(m ²)
Minimum height	6m
Maximum height	6m